

Ergonomic Mounting Systems

The Requirements

It is commonly understood that a truly ergonomic workplace increases the efficiency and productivity of an operator while reducing fatigue, exertion and musculoskeletal disorders.

A truly ergonomic computer mounting system will allow you to adjust your monitor and keyboard in the following five positions—whether you are standing or sitting.

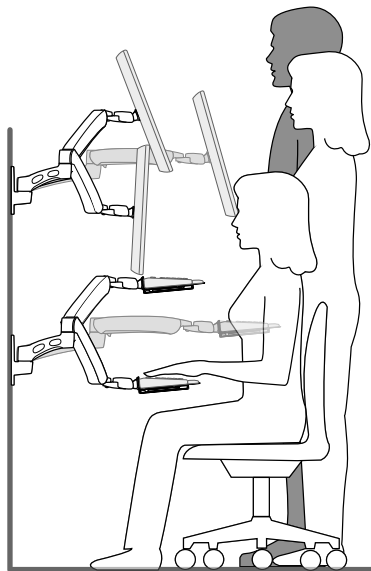

1

Adjust the **monitor height** so that the top of the screen is at or slightly below eye level. Your eyes should look slightly downward when viewing the middle of the screen.

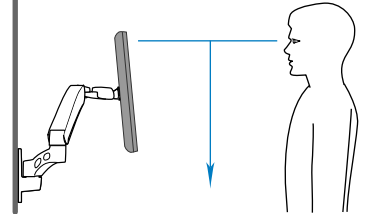

2

Adjust the **monitor distance** to about 20" to 28" or one's arm length.

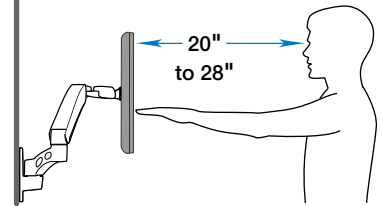

3

Tilt monitor back about 10° to 20° so the top and bottom of the monitor screen are the same distance from your eyes. Make minor adjustments to eliminate glare as needed.

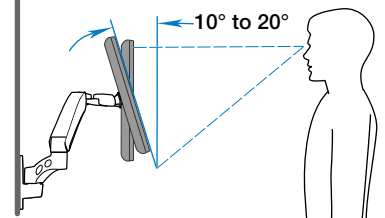

4

Set the **keyboard height** at your elbow height (usually about 20" below the top of monitor screen).

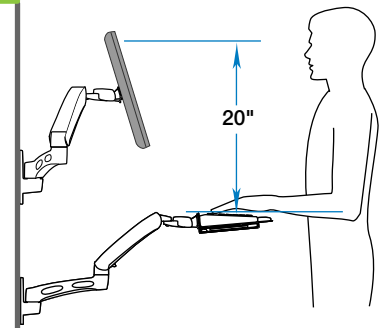

5

Tilt keyboard* so the rear of the keyboard slopes downward at a 5° angle.

* The LX Keyboard Tray is designed with a negative 5° tilt

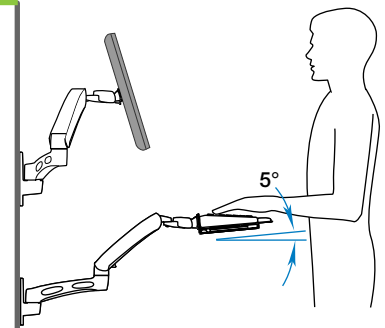

© 2006 Ergotron, Inc. rev. 09/15/2006 e-09-001 Content is subject to change without notification.

Americas Sales and Corporate Headquarters

St. Paul, MN USA
(800) 888-8458
+1-651-681-7600
www.ergotron.com
sales@ergotron.com

EMEA Sales

Amersfoort, The Netherlands
+31 33 45 45 600
www.ergotron.com
info.eu@ergotron.com

APAC Sales

Singapore
www.ergotron.com
info.apac@ergotron.com

Worldwide OEM Sales

www.ergotron.com
info.oem@ergotron.com

